

ISSUE:	DATE:	DESCRIPTION:
LEGEND		TO BE READ IN CONJUNCTION WITH TN 1100 SCHEDULE OF FIXTURES, MATERIALS, & FINISHES.

- EXISTING TREES - RETAINED (REFER TO LANDSCAPE PLAN FOR TREE PROTECTION ZONE DETAILS)
- EXISTING TREES - TO BE DEMOLISHED (REFER TO LANDSCAPE PLAN FOR TREE PROTECTION DETAILS)
- EXISTING PLAYGROUND - TO BE REMOVED
- NEW STORMWATER MANHOLE (REFER TO CIVIL ENGINEERS DETAIL)

NOTES

- *CONSTRUCTION MANAGEMENT PLAN PREPARED BY THE CONTRACTOR MUST COMPLY WITH CONDITION 26 IN DA CONSENT 168/2014.
- *MAKE GOOD TO ALL SURROUNDING LANDSCAPE TO MATCH SURROUNDINGS.
- *REFER TO LANDSCAPE ARCHITECTS DETAIL.
- *REFER CIVIL ENGINEERING DETAIL FOR SEDIMENT & CONTROL PLAN.

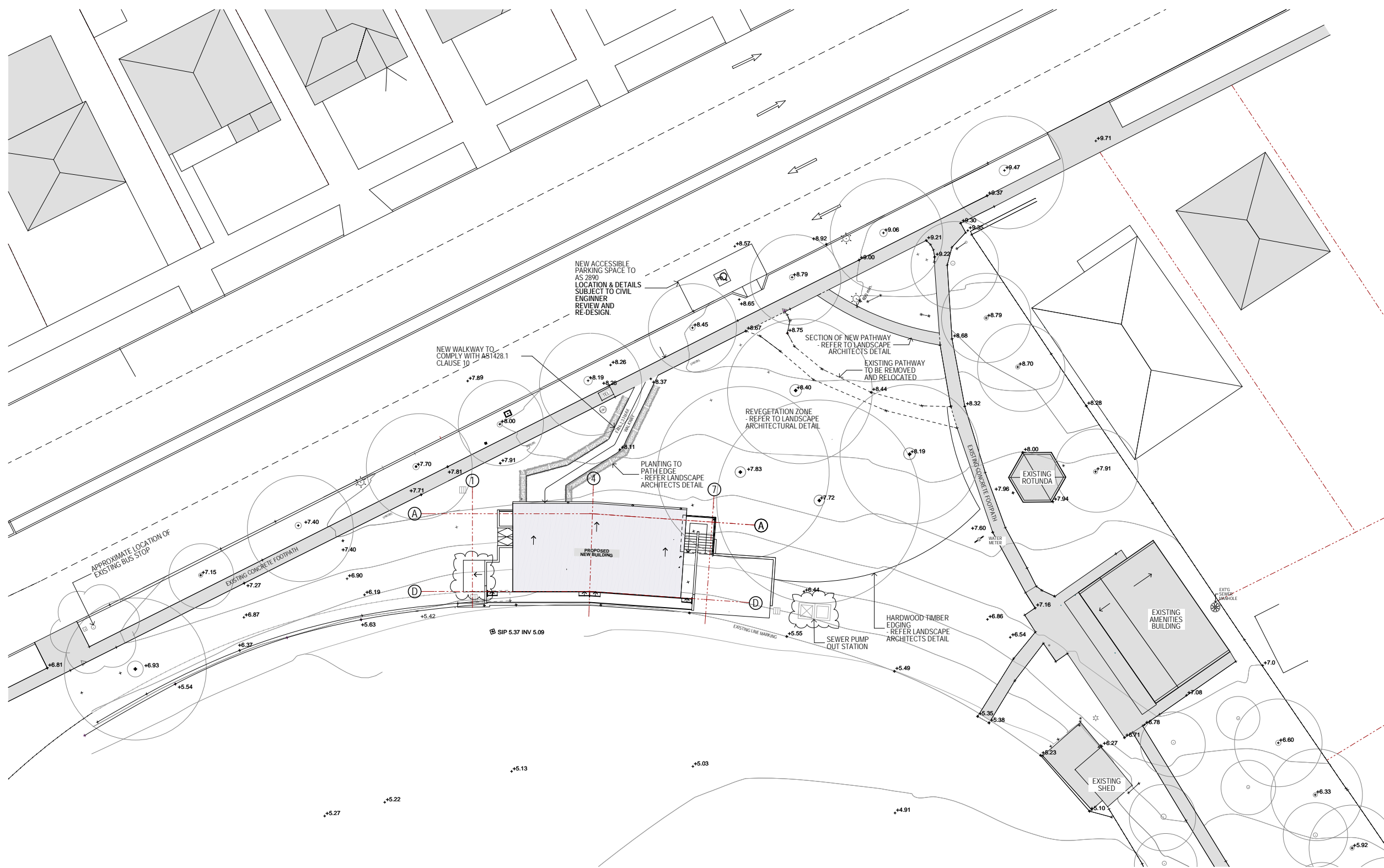

1 PROPOSED SITE PLAN
1:200

PROJECT:
COMMUNITY FACILITY AND AMENITIES BUILDING

FOR:
BRIARS SPORTING CLUB

AT:
ROTHWELL PARK,
CONCORD, NSW

This drawing is protected under the Copyright Act 1968 and is the copyright of Figgis and Jefferson Architects. Do not reproduce, modify or transmit this drawing without the permission of Figgis and Jefferson Architects.

Do not scale this drawing. Use figured dimensions only. Confirm all dimensions and levels on site prior to commencement of any work, preparation of shop drawings or fabrication of components.

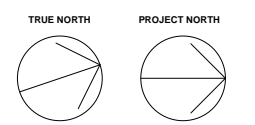

DRAWING TITLE:
PROPOSED SITE PLAN

ARCHITECT:
SF

DRAWN:
DR/PM

LAST PRINTED:
19/12/2016

DRAWING NO.:
3557 TN 101

ISSUE:
G

SCALE: 0m 1 2 3 4 5 @A1